

In-ceiling Mount

SHP-1563FPW
SHP-1563FW

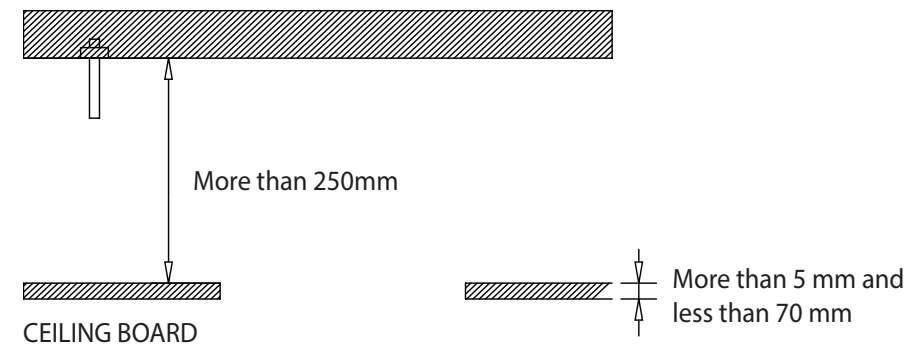

Installation Precautions



- Make sure that the installation place can endure at least 4 times of the total weight of the installation structure.
- At least 250mm or more of spare height is required above the CEILING BOARD.
- Be sure to secure the Safety Wire to avoid a product fall.
- Use the provided screws to install the Mount and camera.
- CEILING BOARD must be able to sustain the weight of at least 10 kg.

2-A

SHP-1563FW

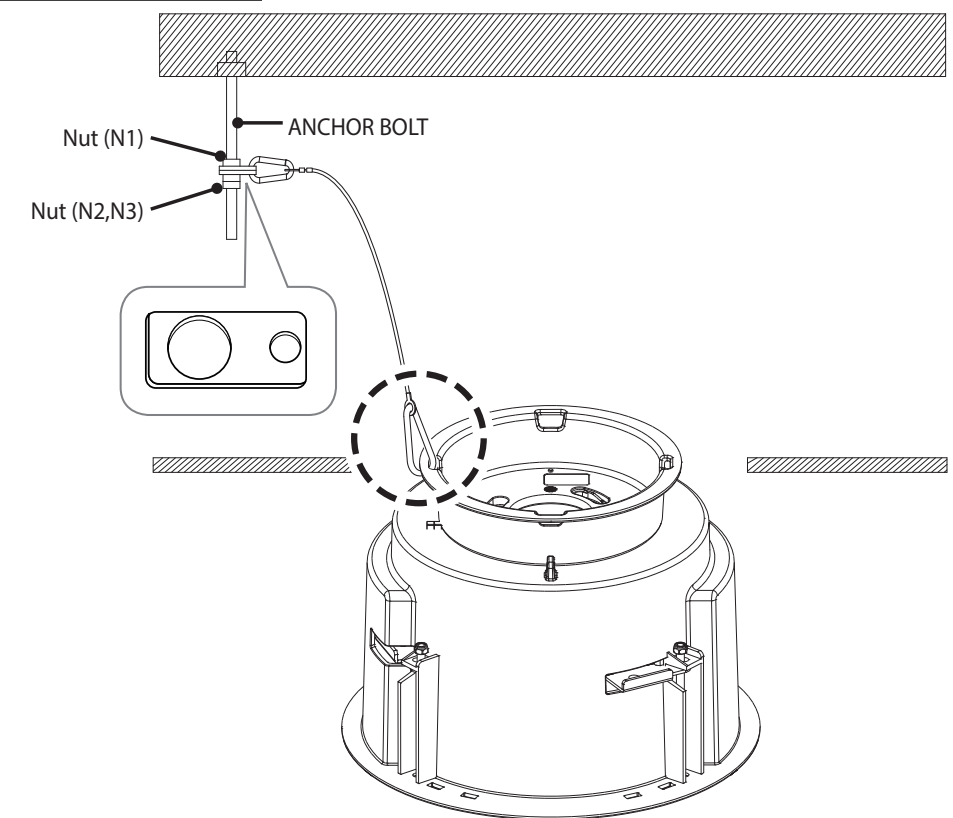

Package

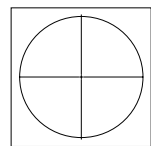

TEMPLATE

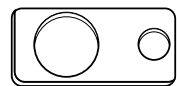

SAFETY BRACKET (1EA)



SAFETY WIRE (1EA)

SHP-1563FW

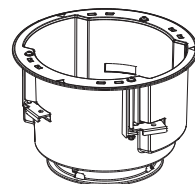

HOUSING



TOP COVER

SHP-1563FPW

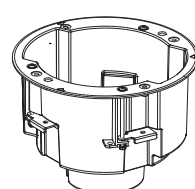

HOUSING



TOP COVER

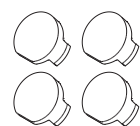

SCREW CAP (4EA)

Installation

1

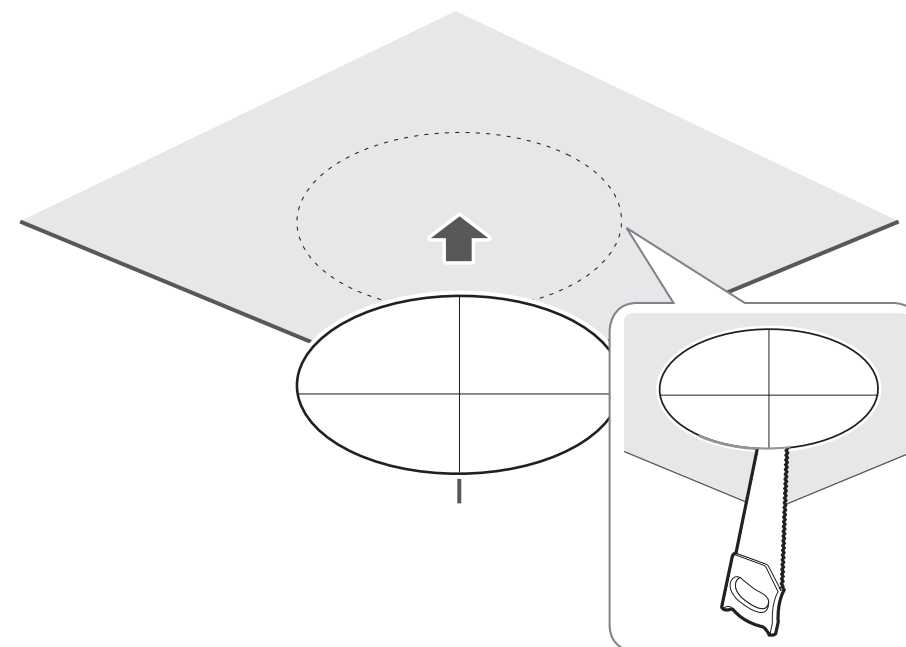

2-B

SHP-1563FPW

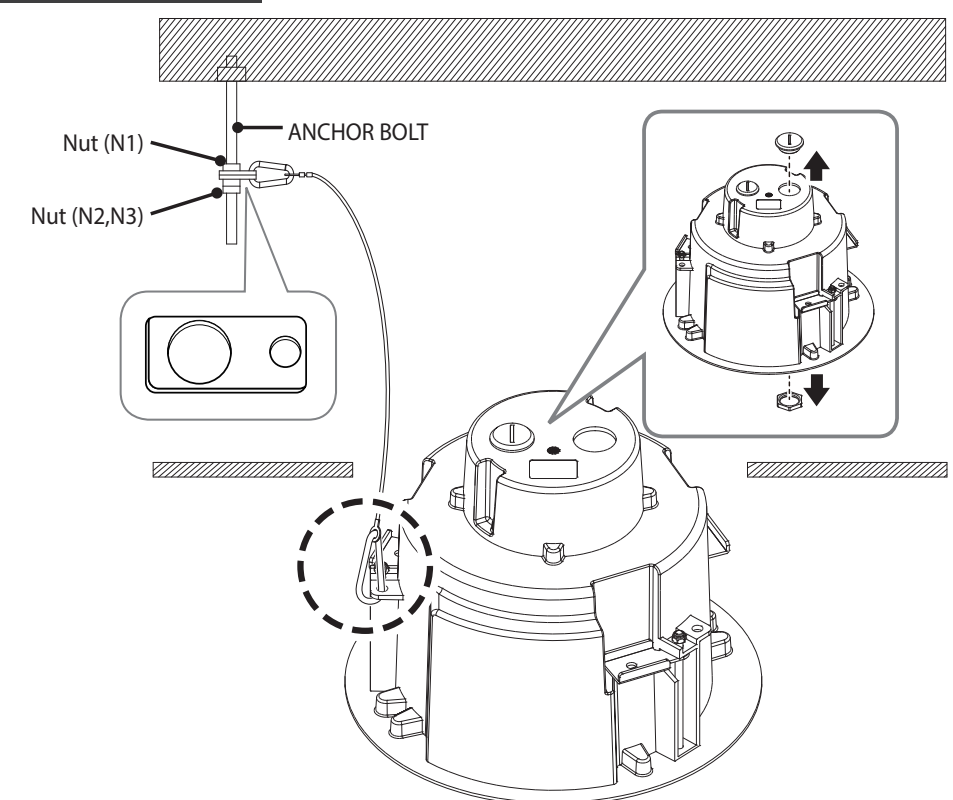

3

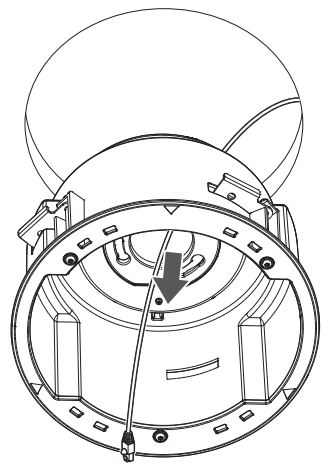

SHP-1563FPW only

Installing using conduit pipe

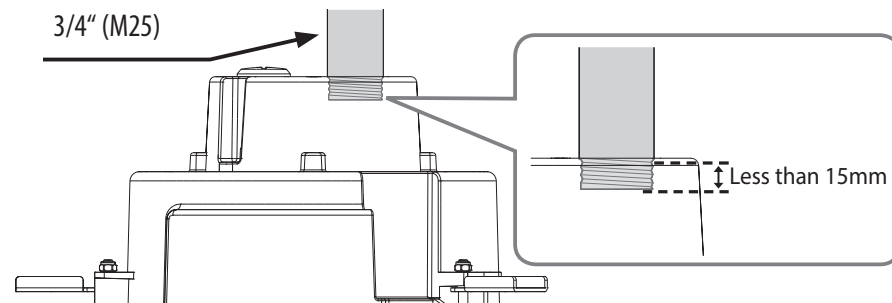

4

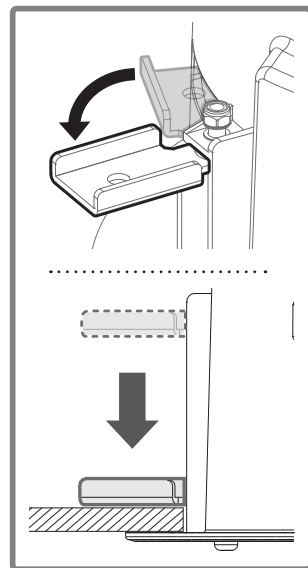
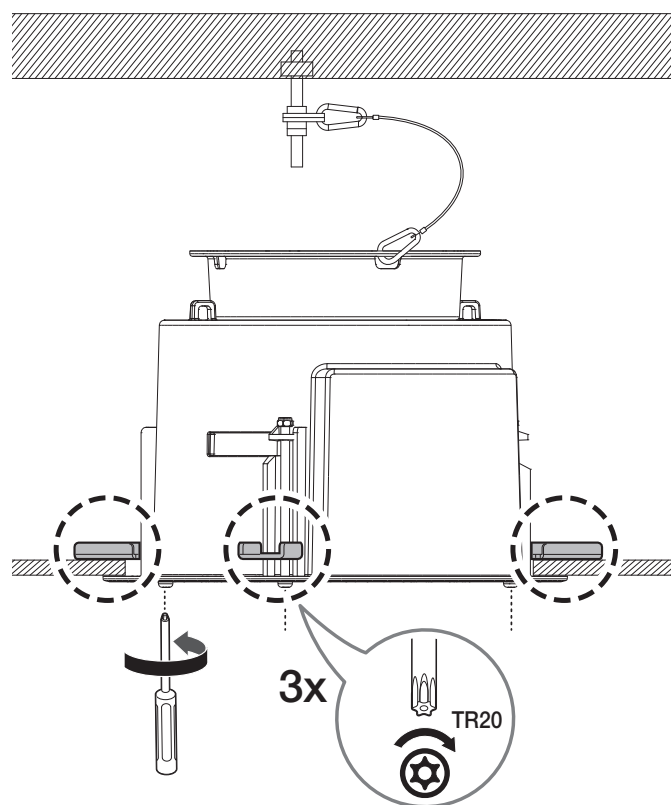

5

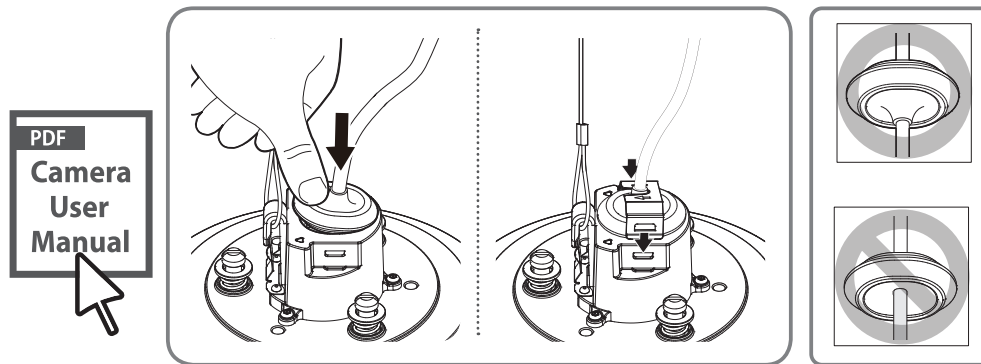
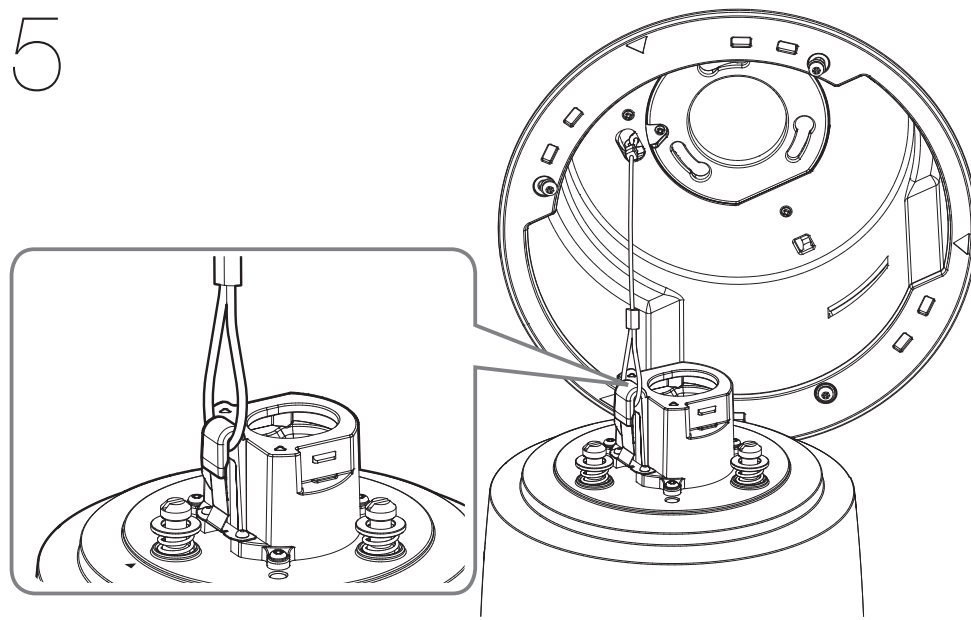

6

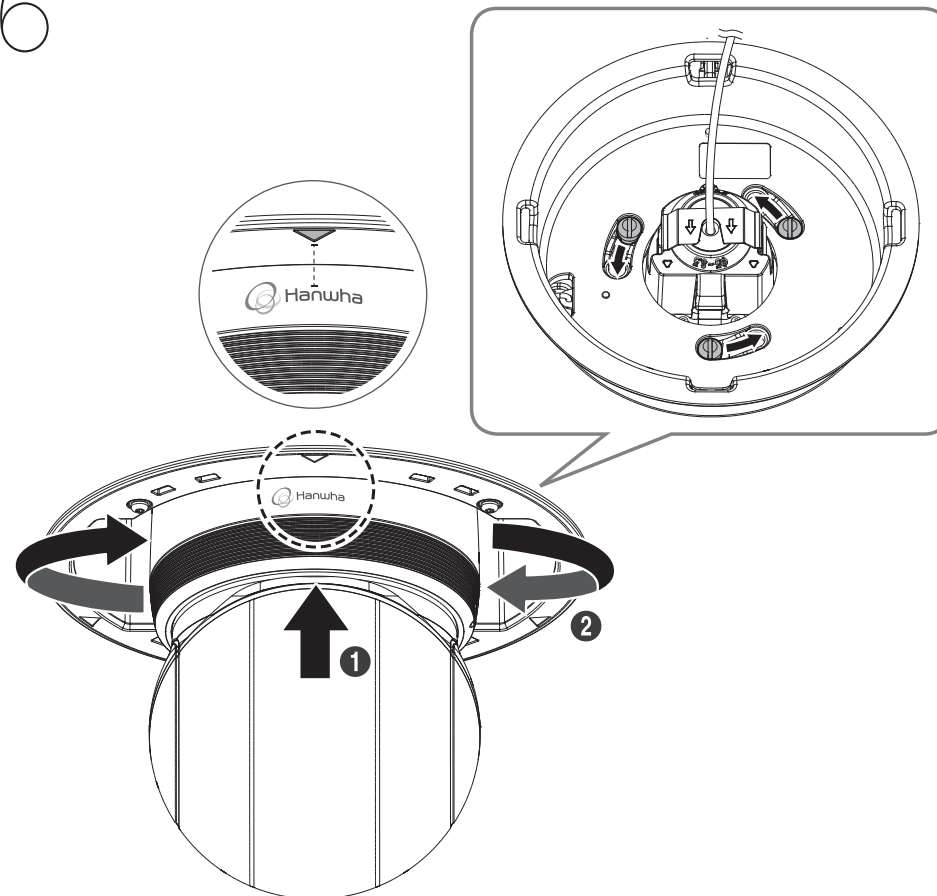

7-A

SHP-1563FW

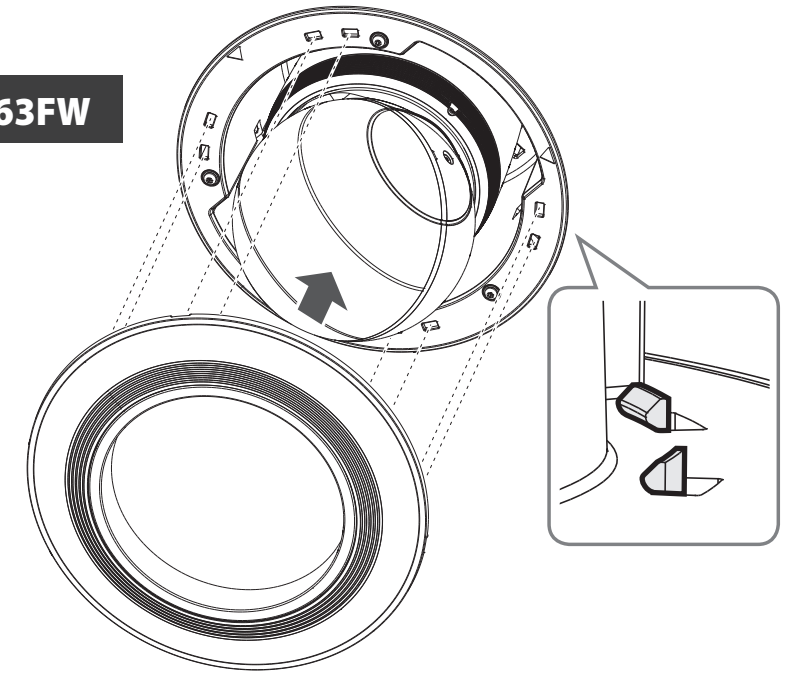

7-B

SHP-1563FPW

1

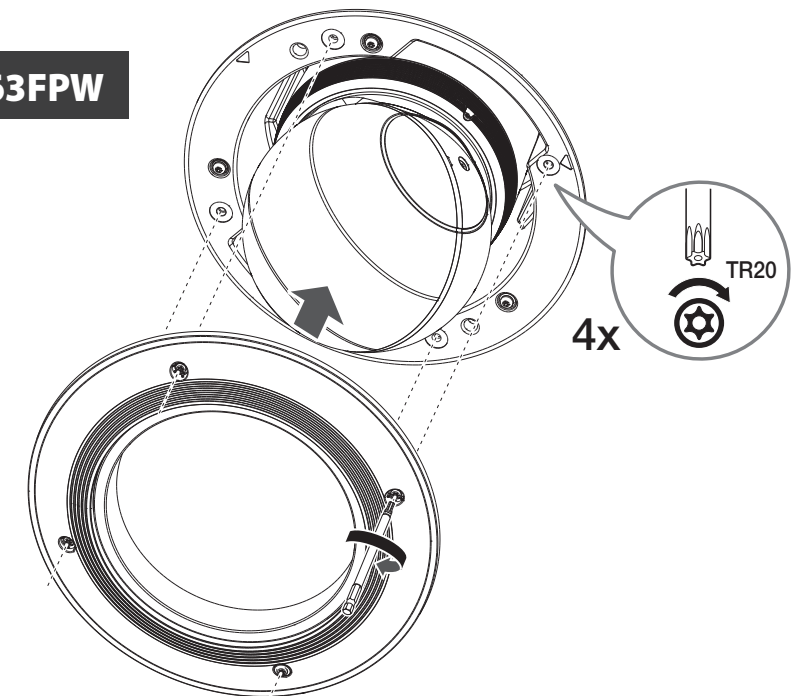

2

